

**PARTS LIST
MODEL H3392**

| No. | Description | Part No. |
|-----|--------------------------|-----------|
| 1 | Retaining Ring (10/pk) | 00009M-03 |
| 2 | Dome Stop | 15097P-01 |
| 3 | Earseal (pair) | 18316G-02 |
| 4 | Filter (1 each) | 14096P-09 |
| 5 | Dome Filter | 25629P-03 |
| 6 | Screw/Grommet Kit (4 pk) | 18900G-47 |
| 7 | Earphone Assembly | 10376G-20 |
| 8 | PCB Assembly | 18289G-13 |
| 9 | Dome Filter | 26475P-02 |
| 10 | Push Button Switch | 09851P-17 |
| 11 | Headpad Assy | 40075G-02 |
| 12 | Headband Spring | 15247P-01 |
| 13 | Temple Pad Assy Kit | 18900G-37 |

| No. | Description | Part No. |
|-----|-----------------------------|-----------|
| 14 | Stirrup & Clamp Kit | 22378G-08 |
| 15 | Switch Cap Kit | 41090G-13 |
| 16 | Switch Guard | 13148P-01 |
| 17 | Left Dome | 15253P-17 |
| 18 | Boom Guide Kit | 12840G-01 |
| 19 | Microphone Cord Assy Kit | 10405G-05 |
| 20 | Communication Cord Assy Kit | 18028G-34 |
| 21 | Microphone Boom Assy | 12765G-04 |
| 22 | DC-1A Microphone w/Cord | 12948G-14 |
| 23 | Microphone Cord Assembly | 10516G-14 |
| 24 | Screen, Wind, Mic | 40062G-06 |
| 25 | DC-1A Microphone | 18920G-04 |

ELECTRICAL SCHEMATIC
MODEL H3392

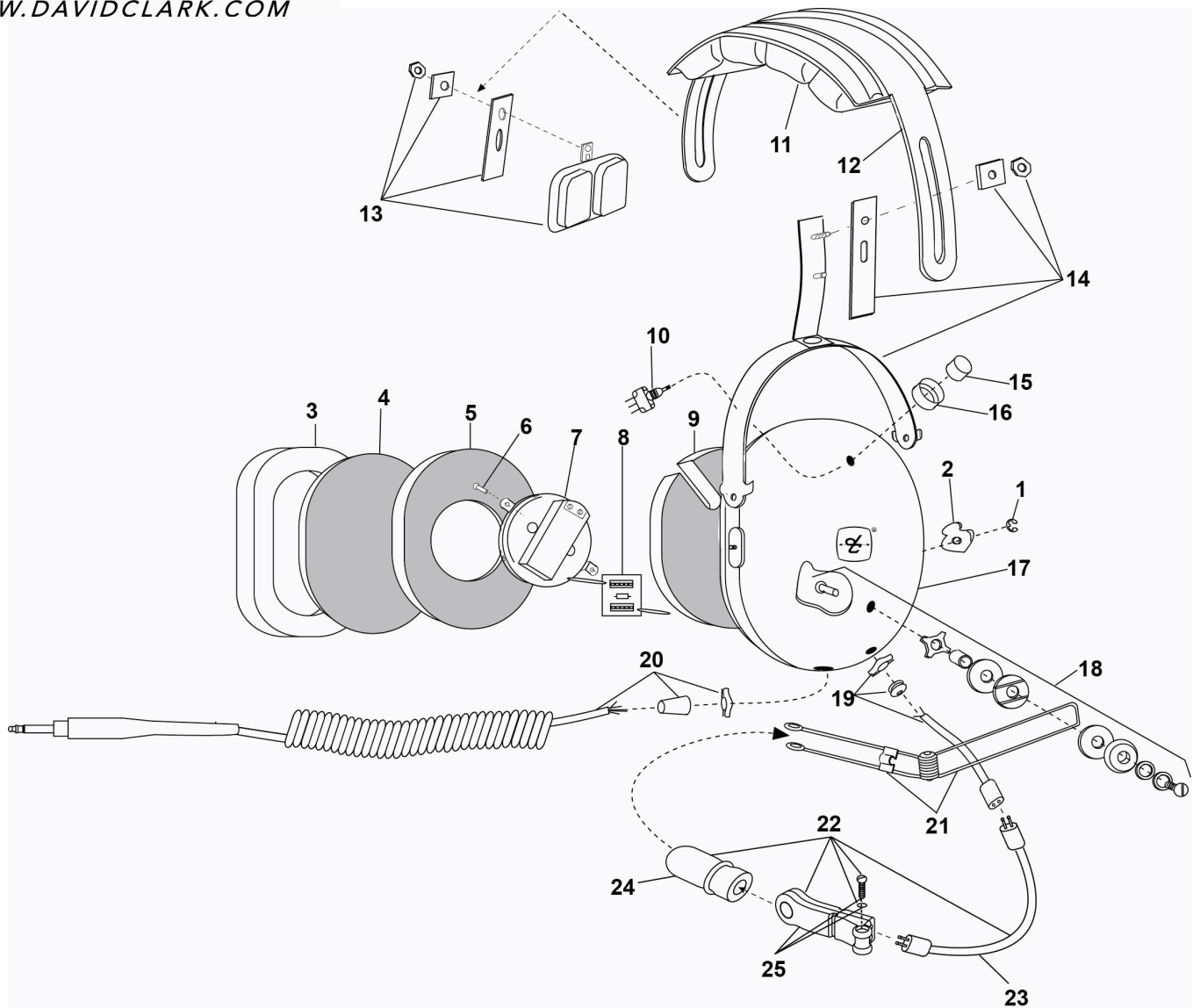