

MATCO ブレーキ (パーツリスト)

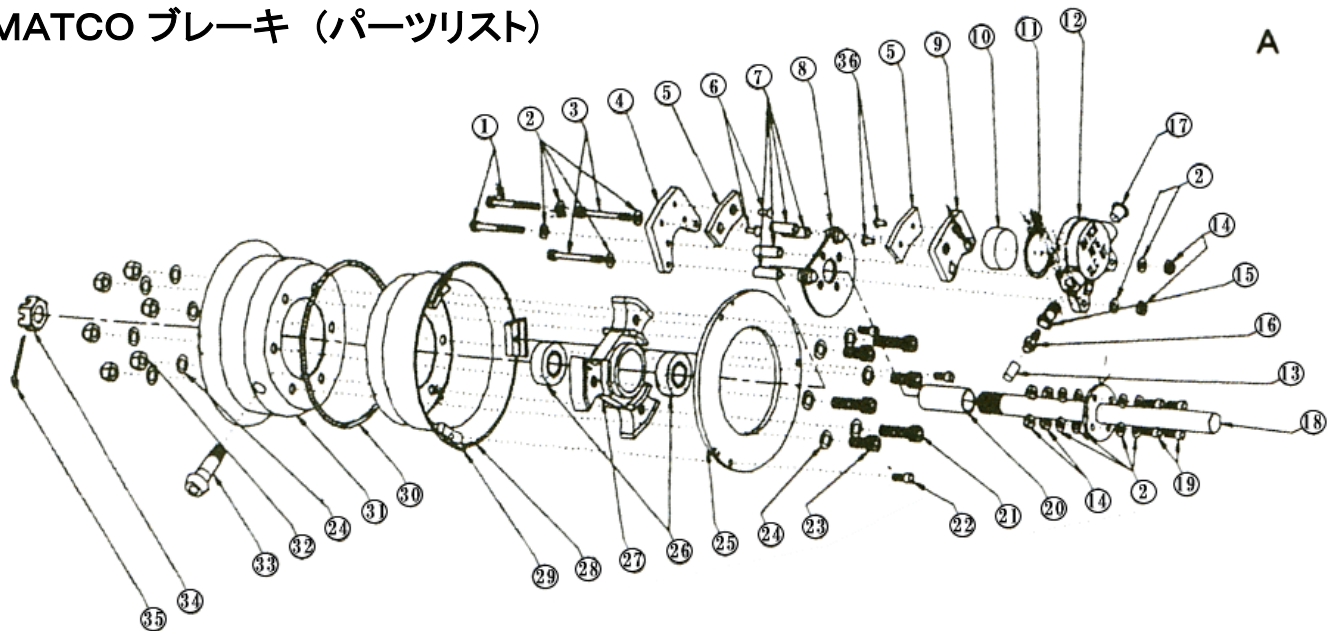

A

| No. | 品名 | 商品番号 | 要数 | 価格 |
|----------------------------------------------|-------------------------------|----------------|----|------|
| 1 | SHCS DRILLED BOLT | 10-24X1.75SHCS | 2 | 530 |
| 2 | WASHER | AN960-10L | 14 | 10 |
| 3 | SHCS | 10-24X1.75SHCS | 2 | 210 |
| 4 | STATIONARY BRK SHOE, 4"/UL | SBS4 | 1 | 6300 |
| SOLE SOURCE WRICO PER MATCO DWG | | | | |
| 5 | LINING, 4"/ULTRA LIGHT | M66-103A | 2 | 2580 |
| 6 | BRASS RIVET | 4-6 | 2 | 40 |
| 7 | SPACER, 4"/ULTRAUGHT BRAXE | BSP4 | 4 | 1560 |
| C12L14 SEAD LOY, .31 ROUND BAR | | | | |
| 8 | BRAKE PLATE, .62 AXLE | BPA.62MH | 1 | 6510 |
| SOLE SOURCE WRICO PER MATCO DRAWING | | | | |
| 9 | MOVEABLE BRK SHOE, 4"/UL BRIC | MBS4 | 1 | 6470 |
| SOLE SOURCE WRICO PER MATCO DRAWING | | | | |
| 10 | PISTON, 4" BRAKE | P1-2 | 1 | 1640 |
| 2011 ALUMINUM ALLOY 1.25 ROUND BAR, EXTRUDED | | | | |
| 11 | O-RING BUNA N | 2-218 | 1 | 280 |
| 12 | PUCK HOUSING, 4" BRAKE | PH-2 | 1 | 6570 |
| SOLE SOURCE MACADAM PER MATCO CASTING | | | | |
| 13 | DUST PLUG | .234-.501L | 1 | 100 |
| 14 | LOCK NUT | 10-24NYLOC | 6 | 50 |
| 15 | BRAKE BLEEDER SEAT | 8BS(A) | 1 | 1580 |
| 16 | BRAKE BLEEDER VALVE | F6446-007 | 1 | 2120 |

| No. | 品名 | 商品番号 | 要数 | 価格 |
|------------------------------------------|----------------------------|----------------------|----|-------|
| 17 | CAPLUG | 2X | 1 | 50 |
| 18 | AXLE, .62 | 17-MA-A4 | 1 | 9860 |
| 4142 NORMALIZED GOLD ROLLED .62 O.D. BAR | | | | |
| 19 | SHCS | 10-24X.62SHCS | 4 | 330 |
| 20 | SLEEVE | MHSL | 1 | 1630 |
| 6061-T6 .75 X .049 SEAMLESS TUBING | | | | |
| 21 | SHCS | .31-18X1.25SHCS | 3 | 220 |
| 22 | SHCS, DRILLED | 10-24X.75SHCS(A) | 3 | 320 |
| 23 | SHCS | .31-18X.75SHCS | 3 | 250 |
| 24 | WASHER | AN960-516L | 12 | 20 |
| 25 | BRAKE DISC, 4" BRAKE | D4(A) | 1 | 13400 |
| 26 | BEARING, .62 | 62-1(KIT) | 2 | 3600 |
| 27 | HUB FRONT W/.62 BEARING | 62-1(KIT) | 1 | 12900 |
| 28 | WHEEL, BRAKE HALF | 62-6-258(A) | 1 | 15700 |
| 29 | MOUNTING LUG, MH68 | ML6 | 3 | |
| 30 | TUBELESS KIT-O-RING BUNA N | 62-121(KIT) | 1 | 480 |
| 31 | WHEEL, VALVE HALF | 62-6-25H(A) | 1 | 11200 |
| 32 | LOCK NUT | .31-18NYLOC | 6 | 50 |
| 33 | TUBELESS KIT-VALVE STEM | 62-121(KIT) | 1 | 230 |
| 34 | .62-18 HEX NUT SLOTTED | .62-18HEXNUT/SLOTTED | 1 | 350 |
| 35 | COTTER PIN 380-3-5 | MS24665-287 | 1 | 50 |
| 36 | BRASS RIVET | 4-4 | 2 | 40 |

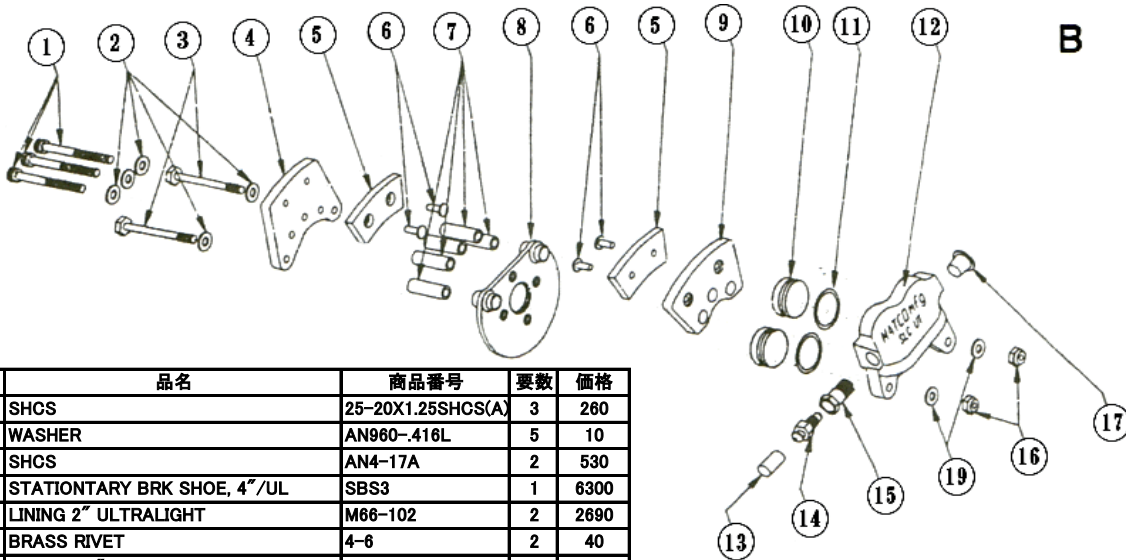

B

| No. | 品名 | 商品番号 | 要数 | 価格 |
|-----|-----------------------------|-------------------|----|------|
| 1 | SHCS | 25-20X1.25SHCS(A) | 3 | 260 |
| 2 | WASHER | AN960-.416L | 5 | 10 |
| 3 | SHCS | AN4-17A | 2 | 530 |
| 4 | STATIONARY BRK SHOE, 4"/UL | SBS3 | 1 | 6300 |
| 5 | LINING 2" ULTRALIGHT | M66-102 | 2 | 2690 |
| 6 | BRASS RIVET | 4-6 | 2 | 40 |
| 7 | SPACER 4"/UL TRALIGHT BRAKE | BSP40 | 5 | 1560 |
| 8 | BRAKE PLATE | VARIES* | 1 | 6510 |
| 6 | BRASS RIVET | 4-4 | 2 | 40 |
| 9 | MOVEABLE BRK SHOE, 4"/UL | MBS3 | 1 | 6470 |
| 10 | PISTON, 4" BRAKE | P1-2D | 2 | 1680 |
| 11 | O-RING BUNA N | 2-210 | 2 | 260 |
| 12 | PLCK HOUSING, 4" BRAKE | P1-3 | 1 | 7120 |
| 13 | DUST PLUG | .234-.501L | 1 | 100 |
| 14 | BRAKE BLEEDER VALVE | F6446-007 | 1 | 2120 |

| No. | 品名 | 商品番号 | 要数 | 価格 |
|-----|--------------------|-------------|----|------|
| 15 | BRAKE BLEEDER SEAT | BBS(A) | 1 | 1580 |
| 16 | LOCK NUT | 25-28NYLOCK | 2 | 50 |
| 17 | CAPLUG | 2X | 1 | 50 |
| 19 | WASHER | AN960-416 | 2 | 10 |

☆LINING BRAKE (ブレーキ ライニング)



#M66-102 ¥2,690(1枚) #M66-103 ¥2,580(1枚) #M66-106 ¥2,720(1枚)